

# The World Leader in Free-Disc™ Pumping Technology



## Model: PVP759

- Adjustable from 2-10psi
- Cast iron construction
- 3" - 10" 125# ASA flanged connection
- Elastomeric faced valve disc
- Horizontal or Vertical mounting
- Working pressure of 200psi
- AIS and Non-AIS versions

Penn Valley Pump Co., Inc. (PVP) provides a fully adjustable back pressure valve for sludge and slurry applications to be used in conjunction with our Double Disc Pump™. In negative head (pumping downhill) applications, the PVP back pressure valve can be used to create head-loss on the discharge side of the pump to provide a more accurate flow rate.

Past methods to remedy the effects of negative head were to either install a piping loop in the discharge (which was not always feasible) or add an actuated valve in the discharge piping. By comparison, the PVP back pressure valve does not require additional piping nor air or electric power. The PVP adjustable back pressure valve is a standard swing-type check valve (which is likely already required in many applications) with a heavy-duty spring and bracket design added to allow the spring tension to be adjusted. This design provides a means to adjust the headloss (think adjustable orifice plate) for each application.

## THE ULTIMATE IN SLUDGE PUMPS™

### Swap-Your-Pump

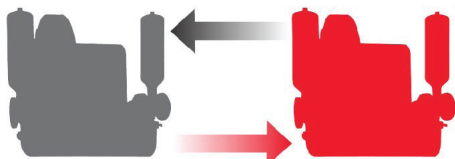

A unique trial program that lets you try before you buy.  
Contact us today to swap-your-pump.

✉ info@pennvalleypump.com

☎ 215-343-8750

📍 Warrington, PA 18976

🌐 www.pennvalleypump.com



## Model PVP759 Adjustable Back Pressure Valve

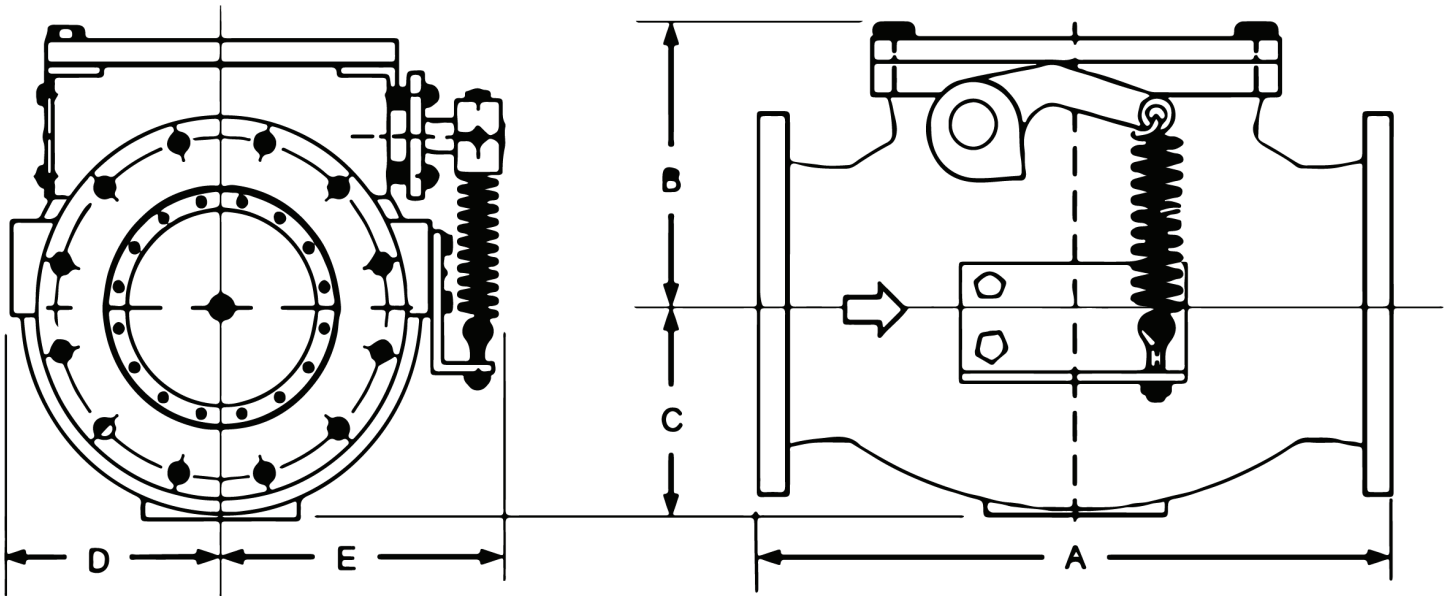

| MODEL        | SIZE | A    | B     | C     | D     | E    | WT  |
|--------------|------|------|-------|-------|-------|------|-----|
| PVP759-3     | 3"   | 9.50 | 6.25  | 3     | 9.75  | 4.25 | 100 |
| PVP759-3AIS  | 3"   | 12   | 7     | 5     | 10    | 5    | 100 |
| PVP759-4     | 4"   | 11.5 | 7.5   | 3.75  | 10.25 | 5    | 150 |
| PVP759-4AIS  | 4"   | 13   | 8.5   | 5     | 11    | 5    | 150 |
| PVP759-6     | 6"   | 14   | 9.5   | 4.875 | 12    | 6.25 | 230 |
| PVP759-6AIS  | 6"   | 17.5 | 9     | 6     | 12    | 7    | 230 |
| PVP759-8     | 8"   | 19.5 | 11.25 | 5     | 14.25 | 7.75 | 310 |
| PVP759-8AIS  | 8"   | 18   | 12    | 9     | 14    | 8    | 310 |
| PVP759-10    | 10"  | 24.5 | 14.25 | 7.5   | 15.25 | 9.25 | 480 |
| PVP759-10AIS | 10"  | 23   | 14    | 9     | 15    | 9    | 480 |

\*All dimension in inches. Weight is in lbs.

\*AIS stands for compliant valve per American Iron & Steel Act